

10115

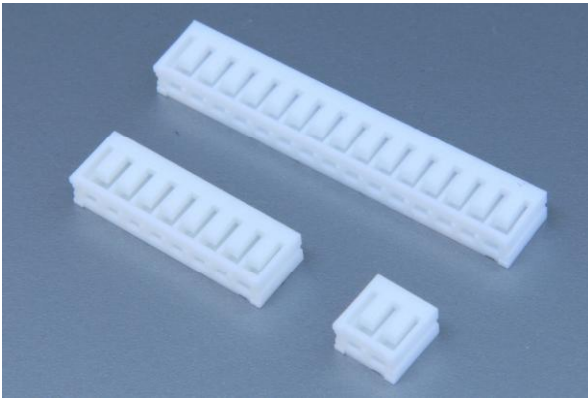

Pitch 2.5mm Board In Connectors



PERFORMANCE

Electrical Rating: AC/DC 250V 2.5A
 額定電壓電流
 Insulation Resistance: 1000MΩ max.
 絕緣阻抗
 Withstanding Voltage: 800V AC/minute
 耐電壓
 Temperature Range: -25°C~+85°C
 適用溫度



HOUSING

Part No.: P101152~P1011516

產品編號

Material: Nylon 94V-0

材質

Suitable Contact: 10115BS-2

配合端子

Applicable Wire: AWG#22~28

適用電線

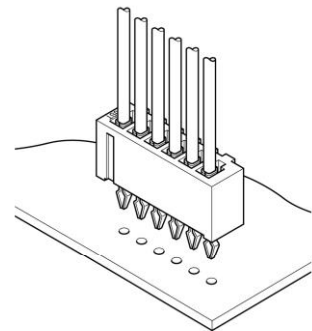

2.5mm

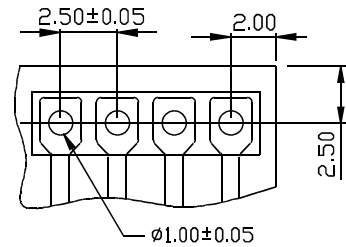
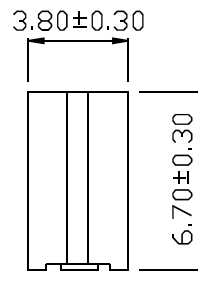
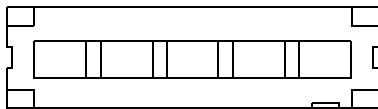
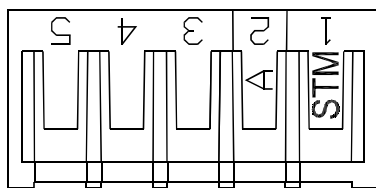
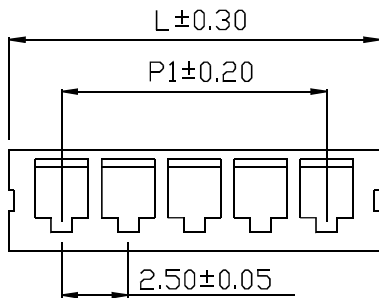

P.C.B LAYOUT

Unit: mm

Part No.	POS.	L	P1	Pack.	Part No.	POS.	L	P1	Pack.
P101152	2	6.50	2.50	1000	P1011510	10	26.50	22.50	1000
P101153	3	9.00	5.00	1000	P1011511	11	29.00	25.00	1000
P101154	4	11.50	7.50	1000	P1011512	12	31.50	27.50	1000
P101155	5	14.00	10.00	1000	P1011513	13	34.00	30.00	1000
P101156	6	16.50	12.50	1000	P1011514	14	36.50	32.50	1000
P101157	7	19.00	15.00	1000	P1011515	15	39.00	35.00	1000
P101158	8	21.50	17.50	1000	P1011516	16	41.50	37.50	1000
P101159	9	24.00	20.00	1000					

Behave in conformity with continual product development policy, SinSheng (STM) reserves the right of specification changing of contents described in this catalogue at any time and without prior notice. Please contact the sales department nearby for most updated information.
 由於產品持續開發的政策, 信盛(STM)保留隨時變更本目錄所述之規格且不需提前通知的權利。請連繫業務處查詢最新的產品資訊。

10115 Board In Connectors

TERMINAL

Part No.: 10115BS-2

產品編號

Thickness: 0.20mm

銅板厚度

Material: Brass

材質 黃銅

Surface Treatment: Tin-plated

表面處理 鍍錫

Applicable Wire: AWG# 22-28

適用電線

Insulation O.D.: 1.20~1.60mm

線皮外徑

Suitable Housing: P101152~P1011516

配合塑膠

Suitable PCB Hole: $\phi 1.0 \pm 0.05$ mm

配合基板孔徑

Thickness: 0.8~1.60mm

厚度

Packing: 10,000PCS(Reel)

包裝數量

PERFORMANCE

Electrical Rating: AC/DC 250V 2.5A

額定電壓電流

Insulation Resistance: 1000M Ω max.

絕緣阻抗

Withstanding Voltage: 800V AC/minute

耐電壓

Temperature Range: -25 $^{\circ}$ C~+85 $^{\circ}$ C

適用溫度



2.5mm

