

# 24038

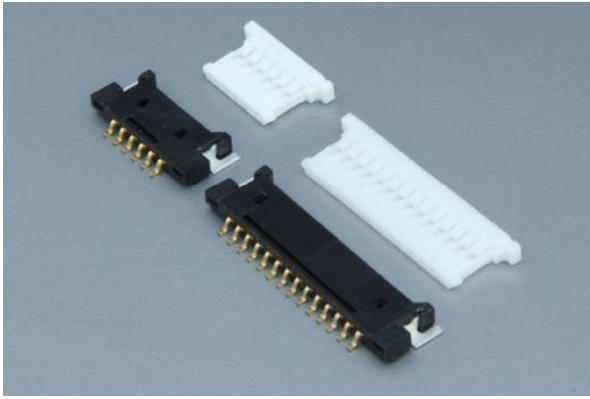

Pitch **1.25mm** Wire to Board Connectors - SMT Type



## PERFORMANCE

Electrical Rating: AC/DC 125V 1A  
 額定電壓電流  
 Insulation Resistance: 100MΩ min.  
 絕緣阻抗  
 Withstanding Voltage: 250V AC/minute  
 耐電壓  
 Temperature Range: -25°C~+85°C  
 適用溫度

1.25mm



## CONNECTOR

Part No.: **MSB24038P2~MSB24038P30**

產品編號

Material: Housing: Nylon 94V-0 Black  
 材質 塑膠座 黑色

Contact Pin: Phos.gold-plated  
 接觸針 磷青銅 鍍金

Reinforcement: Brass, tin-plated  
 補強片 黃銅 鍍錫

Suitable Terminal: 24038PS  
 配合端子

Suitable Housing: P24038P2~P24038P30  
 配合塑膠

Packing: 2,000pcs/reel  
 包裝數量

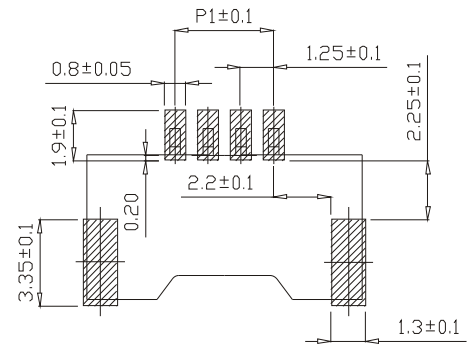

P.C.B LAYOUT (BOTTOM VIEW)

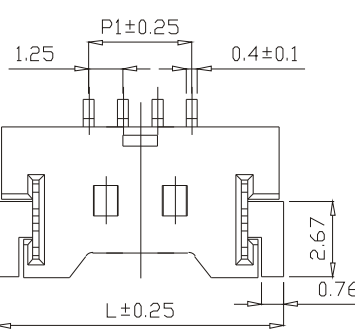
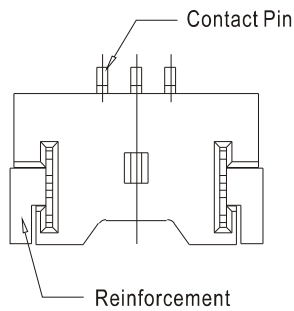

TOLERANCE	
.X	$\pm 0.25$
.XX	$\pm 0.13$
.XXX	$\pm 0.08$

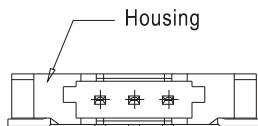

2~3 PIN

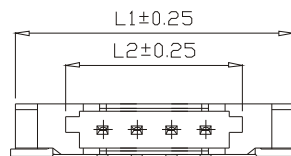

4~30 PIN

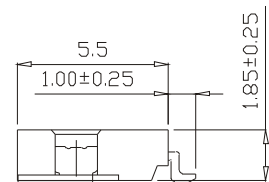

Unit: mm

Part No.	POS.	L	L1	P1	L2	L3
MSB24038P2	2	7.85	7.65	1.25	6.95	4.86
MSB24038P3	3	9.10	8.90	2.50	8.20	6.10
MSB24038P4	4	10.35	10.15	3.75	9.45	7.35
MSB24038P5	5	11.60	11.40	5.00	10.70	8.60
MSB24038P6	6	12.85	12.65	6.25	11.95	11.10
MSB24038P7	7	14.10	13.90	7.50	13.20	12.35
MSB24038P8	8	15.35	15.15	8.75	14.45	13.50

Part No.	POS.	L	L1	P1	L2	L3
MSB24038P9	9	16.60	16.40	10.00	15.70	13.60
MSB24038P10	10	17.85	17.65	11.25	16.95	14.85
MSB24038P11	11	19.10	18.90	12.50	18.20	16.10
MSB24038P12	12	20.35	20.15	13.75	19.45	17.35
MSB24038P13	13	21.60	21.40	15.00	20.70	18.60
MSB24038P14	14	22.85	22.65	16.25	21.95	19.85
MSB24038P15	15	24.10	23.90	17.50	23.20	21.10

Part No.	POS.	L	L1	P1	L2	L3
MSB24038P16	16	25.35	25.15	18.75	24.45	22.35
MSB24038P17	17	26.60	26.40	20.00	25.70	23.60
MSB24038P18	18	27.85	27.65	21.25	26.95	24.85
MSB24038P19	19	29.10	28.90	22.50	28.20	26.10
MSB24038P20	20	30.35	30.15	23.75	29.45	27.35
MSB24038P30	30	42.85	42.65	36.25	30.70	28.60

# 24038 Wire to Board Connectors - SMT Type

## HOUSING

Part No.: P24033P2~P24033P30

產品編號

Material: Housing: P.B.T 94V-0

材質 塑膠座

Suitable Terminal: 24038PS

接觸針 黃銅

Suitable Connector: MSA24038P2~MSA24038P30

補強片 不銹鋼

Applicable Wire: AWG#28~30

適用電線

Packing: 1,000pcs/bag

包裝數量

## PERFORMANCE

Electrical Rating: AC/DC 125V 1A

額定電壓電流

Insulation Resistance: 100MΩ min.

絕緣阻抗

Withstanding Voltage: 250V AC/minute

耐電壓

Temperature Range: -25°C~+85°C

適用溫度



1.25mm

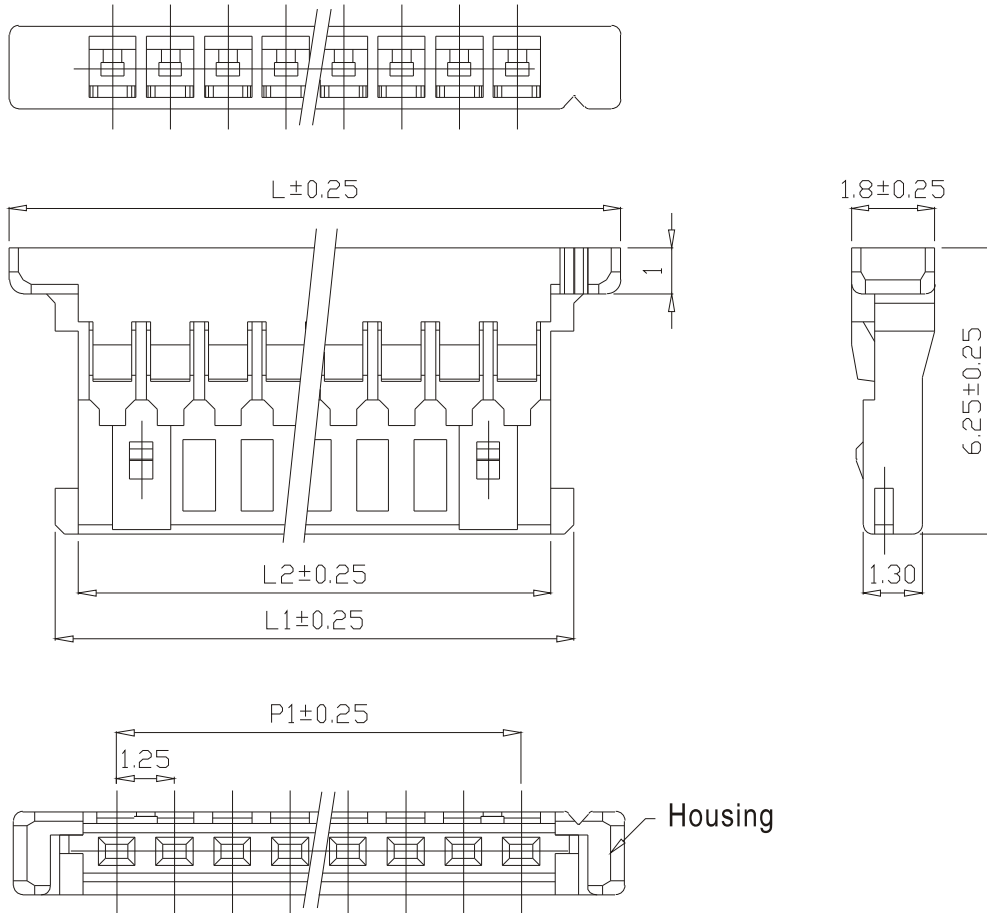

											Unit: mm						
Part No.	POS.	L	L1	P1	L2	Part No.	POS.	L	L1	P1	L2	Part No.	POS.	L	L1	P1	L2
P24038P2	2	5.72	3.72	1.25	2.72	P24038P9	9	14.47	12.47	10.00	11.47	P24038P16	16	23.22	21.22	20.22	18.75
P24038P3	3	6.97	4.97	2.50	3.97	P24038P10	10	15.72	13.72	11.25	12.72	P24038P17	17	24.47	22.47	21.47	20.00
P24038P4	4	8.22	6.22	3.75	5.22	P24038P11	11	16.97	14.97	12.50	13.97	P24038P18	18	25.72	23.72	22.72	21.25
P24038P5	5	9.47	7.47	5.00	6.47	P24038P12	12	18.22	16.22	13.75	15.22	P24038P19	19	26.97	24.97	23.97	22.50
P24038P6	6	10.72	8.72	6.25	7.72	P24038P13	13	19.47	17.47	15.00	16.47	P24038P20	20	28.22	26.22	25.22	23.75
P24038P7	7	11.97	9.97	7.50	8.97	P24038P14	14	20.72	18.72	16.25	17.72	P24038P30	30	40.72	38.72	37.72	36.25
P24038P8	8	13.22	11.22	8.75	10.22	P24038P15	15	21.97	19.97	17.50	18.97						

### TERMINAL

Part No.: **24038PS**

產品編號

Material: **Phos.**

材質

磷青銅

Suitable Housing: **P24038P2~P24038P30**

配合塑膠

Applicable Wire: **AWG#28~30**

適用電線

Outside Dimension: **0.9mm Max.**

線皮外徑

Packing: **2,000pcs/reel**

包裝數量

### PERFORMANCE

Electrical Rating: **AC/DC 125V 1A**

額定電壓電流

Insulation Resistance: **100MΩ min.**

絕緣阻抗

Withstanding Voltage: **250V AC/minute**

耐電壓

Temperature Range: **-25°C~+85°C**

適用溫度

1.25mm

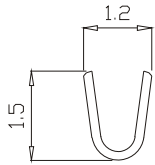

A-A

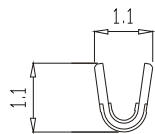

B-B

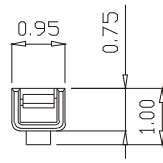

C-C

